

1 Our sincere gratitude

Takeway® R1 Ranger Clampod is another revolutionary breakthrough after **T1** Clampod. The ultra-lightweight **R1 Ranger** Clampod is built for the "outdoor enthusiasts" group. The **R1 Ranger** Clampod weighs only 73g and is portable and convenient to use for consumer electronics such as action cameras, smartphones and tablets. The **R1 Ranger** Clampod can be easily disassembled without tools and has a maximum load capacity of 3kg. The **R1** will not loosen even when it is used while moving around, and can be matched with different accessories. This provides users with versatility based on user requirements. Not only can it be clamped onto tubes, it can also be secured on flat surfaces and be placed in pockets. Even extreme sports will not affect its function, so enjoy every moment and explore new experiences with **Takeway® R1 Ranger** Clampod!

2 Please test the relevant components and read the responsibility statement before using this product

On your electronic products, please check **Takeway® R1 ranger** clampod and its accessories for damage or deformity. If there is any, please contact the salesperson to exchange your product to prevent damage to your electronic products or personal injury caused by the flawed product. The company takes no responsibility and assumes no liability for the loss or inconvenience caused by user's own negligence.

3 Product components

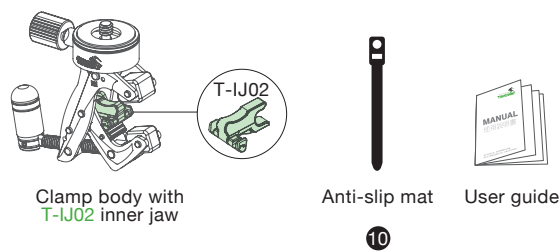

4 Operation notes

4-1: When using on a flat surface, use the grid side of the clampod for stability or use the smooth side of the clamp to protect the surface from damaging.

4-2: When clamping on a smooth cylindrical surface, place the anti-slip mat between the surface and the clampod to increase grip.

4-3: The body of the clamp is made of aluminium alloy, but do not place the product in a humid environment for a long time to avoid product being damaged.

4-4: Do not place the product near heat or an open flame which will damage the plastic components.

4-5: If the product has not been used for a long time, please check the components and functions work normally, so that it does not fall when it is used on the electronic products.

4-6: After the product is assembled, please place it on a flat surface to check for its stability. When using this product for standing shooting, do not remove your hands from your electronic product when installing it on the clamp. Make sure that the clampod stands on the surface before shooting, so that your electronic product will not be damaged caused by the fall of the clampod.

4-7: Please follow the installation instructions below when utilizing this product. First, clamp and secure the **R1 Ranger** Clampod, then use the attached quick release clip to mount your electronic device and prevent your device from falling and getting damaged.

4-8: When installing the quick release plate to electronic devices or accessories, please make sure that the quick release plate is screwed in tightly to prevent it from loosening and falling.

5 Parts name

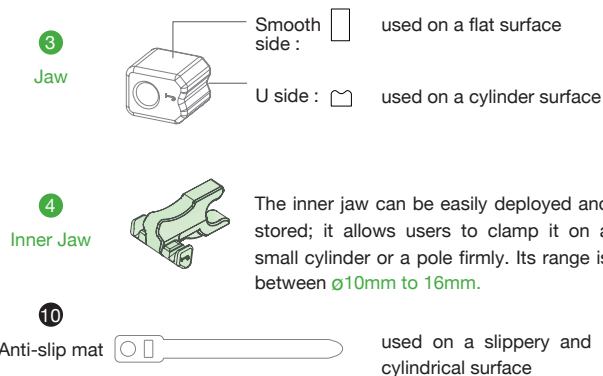
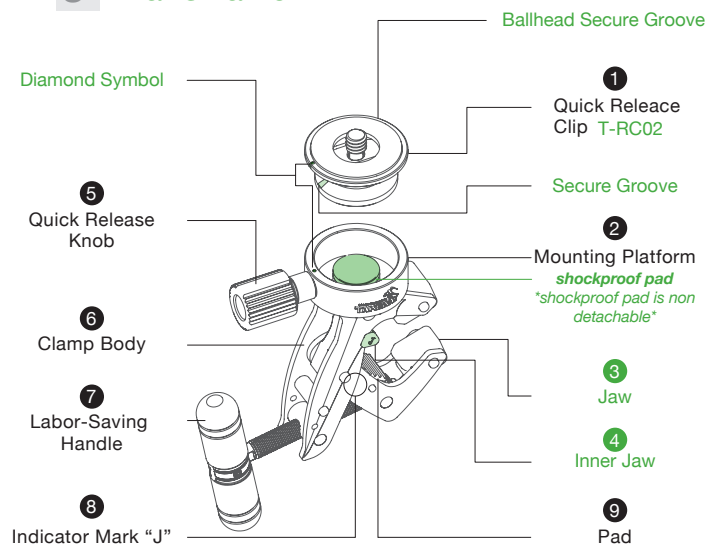

6 Assembly and operation

6-1: Anti-slip mat assembly, disassembly and storage

Assemble and place the **1** anti-slip mat in between a smooth cylindrical surface and the **R1 Ranger** Clampod to increase stability of the clampod and to avoid sliding. The mat can also be stored between the quick release knob and the mounting platform to prevent it from getting lost.

6-1-1: Storing the anti-slip mat

As the figure shows, store the **10** anti-slip mat between the **5** quick release knob and the **2** mounting platform.

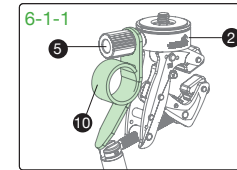

6-1-2: Using the anti-slip mat

As the figure shows, wrap the **10** anti-slip mat on the **6-1-2** cylinder to be gripped. Then use the **3** square jaw to clamp the anti-slip mat to increase grip.

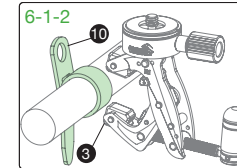

6-2: The installation marks are on the secure groove

The **secure groove** is designed to increase stability and to prevent the quick release clip from loosening. Installation marks are marked on the quick release parts to ensure fast and accurate installation.

6-2-1: Line up the installation marks on both the **1** quick release clip and the **2** mounting platform (attached to the accessories or electronic devices) and tighten the **5** quick release knob to complete installation.

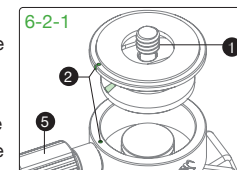

6-3: Use of the inner jaw

For better convenience and stability, use the **inner jaw** to secure the object when clamping the **R1 Ranger** Clampod on small tubes. The **inner jaw** is made of high-grade, high-strength reinforced plastic. The jaw comes installed in the clamp from the factory. Do not remove inner jaw unless necessary to prevent the jaw from being lost.

6-3-1: Use with inner jaw

Move the securing position of the **inner jaw** downward to the center to attach to cylinders. After securing, shake gently to make sure it is tight to prevent items from coming loose and falling.

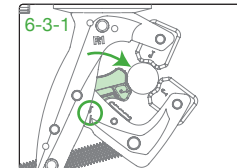

6-3-2: Clamping range

This product comes with a clamp indicator mark. When clamping exceeds the mark as shown in the below diagram, the inner jaw can be used to clamp the cylinder and maintain stability.

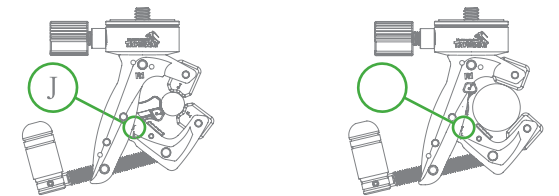

* When you see the "J" indicator mark (Ø10 ~ Ø16mm), use the jaw and the inner jaw to make a "3 J-point clamp" (please note the "J" mark on the jaw).

When you can't see the "J" indicator mark (Ø17~ Ø32mm), use the inner parts of the clamp body for clamping. At this time the inner jaw should be folded

6-4: Instructions for clampod usage

To choose a proper usage for clamping, please refer to **6-3-2: Clamping Range**. When clamping smooth cylindrical surface, please refer to **6-1-2: Using the anti-slip mat**.

6-4-1: Clamp and secure the clampod on the object to be gripped. As shown in the figure, **7** the convenient handle fixing point can be bent for more flexible application in limited space. This also can be rapidly and conveniently done with less effort.

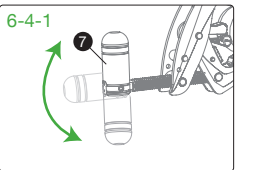

6-4-2: Clamp the **R1 Ranger** Clampod to a proper location and shake gently to make sure it is firmly secured to prevent items from loosening and falling.

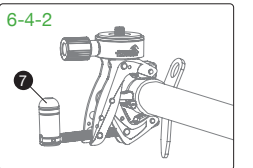

6-5: T-B01 Ballhead installation and use (optional accessories)

The **T-B01 Ballhead** in this installation instruction is an accessory designed for **T1** Clampod and is sold separately.

6-5-1: Loosen the **5** quick release knob and remove the **1** quick release clip.

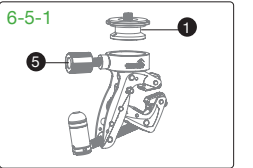

6-5-2: Attach the ❶ quick release clip to the ballhead with a coin or a flathead screwdriver. Please make sure that the locking mechanism at the base of the Ballhead is lined up coin with the A secure groove on the quick release plate to prevent the Ballhead from loosening and causing items to fall.

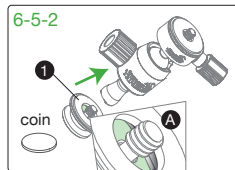

6-5-3: Line the installation mark with the ❶ quick release clip with the attached Ballhead (please refer to 6-2: The installation mark on the security groove) and slide in the ❷ mounting platform.

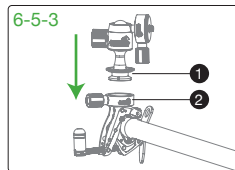

6-6: Mounting and using the T-PH02 use smartphone holder (optional accessory)

The T-PH02 use smartphone holder in the following instruction is an optional accessory that is sold separately. We recommend purchasing and using it with the T-B01 Ballhead for more flexible angles to use.

6-6-1: Clamp and secure the R1 Ranger Clampod on the object. Please refer to 6-4: Instructions for clampod usage. Loosen the ❸ quick release knob and remove the ❶ quick release clip.

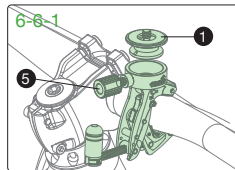

6-6-2: Attach the A sport smartphone holder on the ❷ mounting platform and adjust it to a proper position, then tighten the ❸ quick release knob. It is now ready for use.

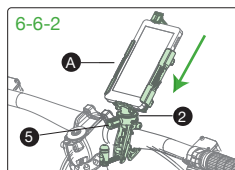

6-7: Mounting and using the T-FN01 Flex neck (optional accessory)

T-FN01 goose neck in this instruction is an optional accessory. The following instructions are only recommended to be used in a static environment or in a vehicle.

6-7-1: Clamp and secure the R1 Ranger Clampod on the object. Please refer to 6-4: Instructions for clampod usage. Loosen the ❸ quick release knob and remove the ❶ quick release clip:

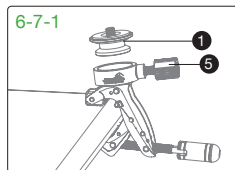

6-7-2: Attach the ❷ quick release clip of the flex neck to the ❸ mounting platform. Tighten the ❷ quick release knob to finish the mounting. Use with other accessories can extend the length and add more shooting angles.

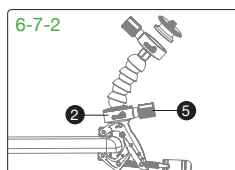

7 Mounting and operating action camera

7-1: Mounting a action camera

The T-RC03 action camera quick release plate in this instruction is an optional accessory that is sold separately.

7-1-1: To secure the R1 Ranger Clampod on the clamped object, please refer to 6-4: Instructions for clampod usage. Loosen the ❸ quick release knob and remove the ❶ quick release clip.

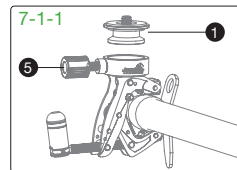

7-1-2: Mount the A T-RC03 quick release clip on the base of the action camera case. Secure with a screwdriver. Please be certain that it is firmly installed to prevent the product from loosening during intense movement.

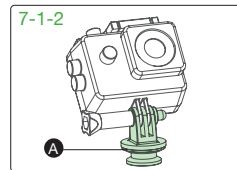

7-1-3: Install the action camera mounted with the A T-RC03 quick release clip to the ❷ mounting platform (please refer to 6-2: The installation mark on the security groove). After adjusting the clip to the proper location, tightening the ❸ quick release knob. Now it is ready for use.

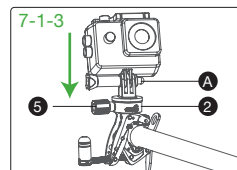

8 Safety warning

8-1: Please follow the operation notes. The company takes no responsibility for any man-made damage.

8-2: Please do not take your hands away from the clampod before it is fully stabilised, or your electronic product might be damaged from falling.

8-3: The product has a strong clamping force. Please do not screw too tight, so that it will not damage the clamped object.

8-4: Do not apply any volatile solvents (kerosene, paint thinner) on the product surface.

8-5: If the product is damaged or deformed from falling or impact, please stop using the product anymore, so that your electronic product will be damaged from any malfunction.

8-6: An adult must accompany when children under the age of 12 are using the product.

8-7: For your safety, please do not use any electronic device while driving a vehicle.

9 Specifications of the product

Model number: R1

Size: 7.5(L)x6.5(W)x3.2(H)cm

Weight: 73g

Materials: Aerospace-grade Aluminium Alloy, Nylon.

Screw of the quick release plate: 1/4"

Clamping range: Ø10 ~ Ø32mm, Clamping Flat Surface: 5-32mm

Clamp Load Capacity

For dynamic:300g

For static:it depends on the optional accessory's own design.

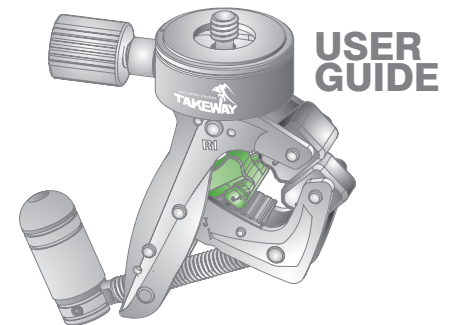

Before using the product for the first time, please read through the user guide.

Please use this product correctly after fully understanding the content of the user guide.

10 Optional Accessories

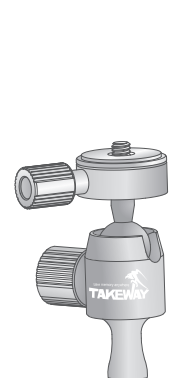

T-B01
Ballhead



T-PH02
Phone Holder For Sports

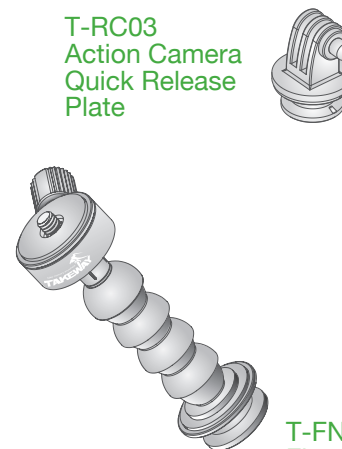

T-RC03
Action Camera
Quick Release
Plate



T-FN01
Flex Neck

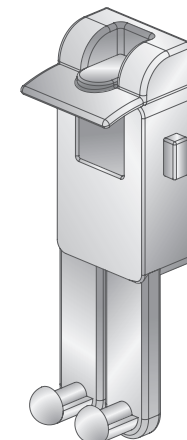

T-TH01
Tablet Holder

All information described in this user guide is based on the test standard of Takeway . Sorry for the inconvenience caused if there are any errors. The design and specifications of this product are subject to change without notice.

Copyright: All Rights Reserved

EHOMA INDUSTRIAL CORPORATION

TEL: +886-4-2406 5031

info@takeway.tw

www.takeway.tw